

KARTECH ENGINE

Although only recently gaining popularity in some countries, the Yamaha KT100S and KT100J engines have been a major part of the Australian karting scene for over 20 years. DPE's vast competition experience and technical knowledge have resulted in a wide range of race proven products, providing the karter with the very best in quality and performance.

Kartech engine parts are a wide range of products, combining those that are designed and manufactured exclusively for DPE, others that we manufacture ourselves, together with the highest quality parts sourced from all around the world, including genuine Yamaha products.

Whenever you think Yamaha engines, think Kartech engine parts first...

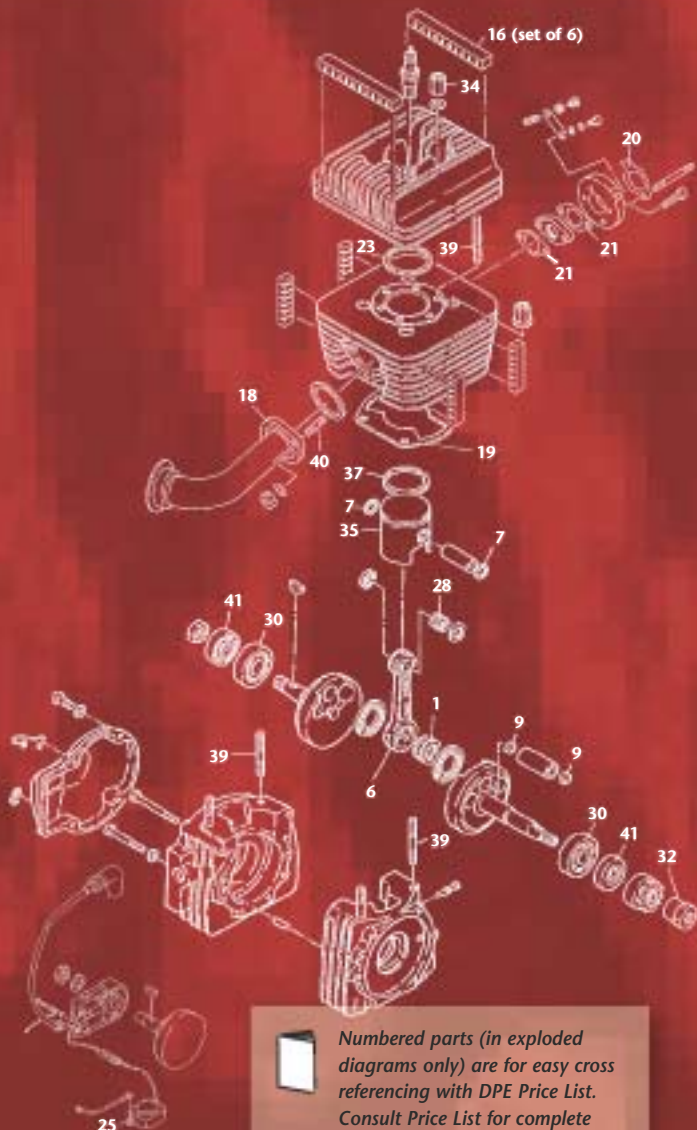

Numbered parts (in exploded diagrams only) are for easy cross referencing with DPE Price List. Consult Price List for complete listing of product codes, sizes etc.

35 Pistons

- ESPK___• KSI
- ESP___• Yamaha

(Note that numbers indicate size)

A choice of brands offering top quality, along with a comprehensive range of sizes.

KSI 'Super Blue': 52.02 - 53.00mm
Standard: 53.10 - 53.50mm



37 Piston Rings

- ESRK00• → •ESRK9053• Kartech
- ESRT05• → •ESRT9535• KSI

(Note that numbers indicate size)
Teflon coated for ease of running in and improved sealing. Manufactured to fine tolerance, so end gaps are correct. Available in a wide range of sizes.

Kartech: 52.00-53.00mm
KSI: 52.05-53.50mm



AKA Cylinder Sealing Nut 34

- ESNCA•
- AKA legally approved sealing nut



Conrods 6

- ESCOJ• Genuine Yamaha, crack tested (light 'J' rod)
- EJCOT• Genuine Yamaha, crack tested, hardness tested & checked for straightness ('J' rod)
- ESCO• Mid weight
- ESCOK• KSI



PARTS Yamaha KT100S



Fin Damper Set (16)

•**ESCYD**• includes 4 short (head) & 2 long (cylinder)



(7) **Circlips**
European made, 14 x 1.0mm

- ESCP**• earless
- ESCP**• with ears



Cylinder Base Gaskets (19)
4 sizes for quick and easy adjustment of the cylinder/head position

- ESGB075**• 0.075mm
- ESGB1**• 0.1mm
- ESGB2**• 0.2mm
- ESGB4**• 0.4mm



Big End Cages (1)

- ESBEK**• Thompson 17mm wide, use with little end spacers (6 per roll)
- ESBEKN**• Thompson 14mm wide, use with big end spacers (7 per roll) (•**ESBEKNK**• KSI 14mm wide)



(28) **Little End Cages**

- ESLE03**• Thompson brand 17mm wide, use with little end spacers/Yamaha KT100J engines (6 per roll)
- ESLE03W**• Thompson brand 19mm wide, use with located big end (5 per roll)
- ESLE03WK**• KSI brand 19mm wide (5 per roll)



(39) **Cylinder & Head Studs**

- ESS2**• Cylinder/Head Stud
- ESS3S**• Stepped stud to repair stripped threads

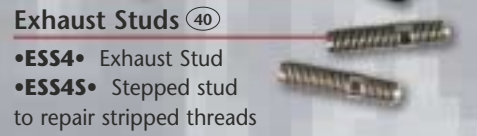

(40) **Exhaust Studs**

- ESS4**• Exhaust Stud
- ESS4S**• Stepped stud to repair stripped threads



(21) •**ESGCA1**• Carburettor gasket

(20) •**ESGC1**• Carburettor gasket



(23) **Head Gaskets**
4 thicknesses for quick and easy adjustment of cylinder head

- ESGH12**• 1.2mm
- ESGH9**• 0.9mm
- ESGH75**• 0.75mm
- ESGH6**• 0.5mm



(32) **Crankshaft Nuts**

- ESNCD**• to suit early model engines with 10mm diameter crank, 10-14mm tapered shaft
- ERNCD**• to suit late model engines with 12mm diameter crank, 12-15mm tapered shaft



(34) **Cylinder Head Nut Set**

- ESNH6**• set including 6 nuts & washers
- ESNH**• nut only

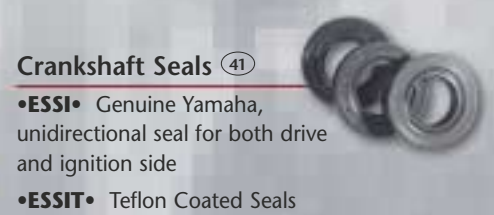

(41) **Crankshaft Seals**

- ESSI**• Genuine Yamaha, unidirectional seal for both drive and ignition side
- ESSIT**• Teflon Coated Seals

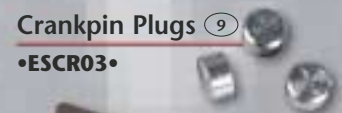

(9) **Crankpin Plugs**

- ESCR03**•

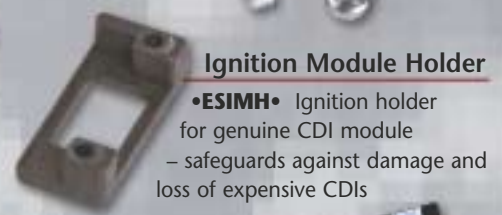

Ignition Module Holder

- ESIMH**• Ignition holder for genuine CDI module – safeguards against damage and loss of expensive CDIs

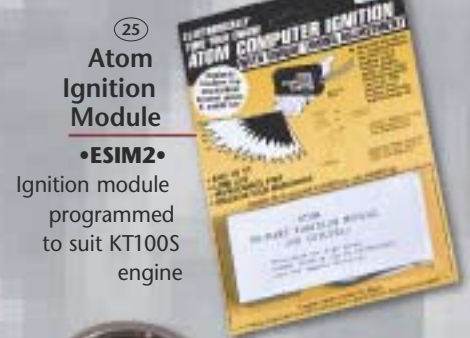

(25) **Atom Ignition Module**

- ESIM2**• Ignition module programmed to suit KT100S engine



(30) **Main Bearings**

- ESM6304/9**• Superior bearings containing nine balls which contributes to lower inertia, meaning faster acceleration/deceleration, higher RPM limit and increased load limit. The ultimate main bearing!



(18) **Exhaust Headers**

- ESEHK**• 200mm length
- ESEHK2**• 165mm length

Large diameter, mandrel formed for improved flow and performance

Powermac Exhaust Headers

- ESEHKP**• 165mm length
- ESEHKPL**• 200mm length

Stainless steel, expanded to maximum diameter (36.0mm)